

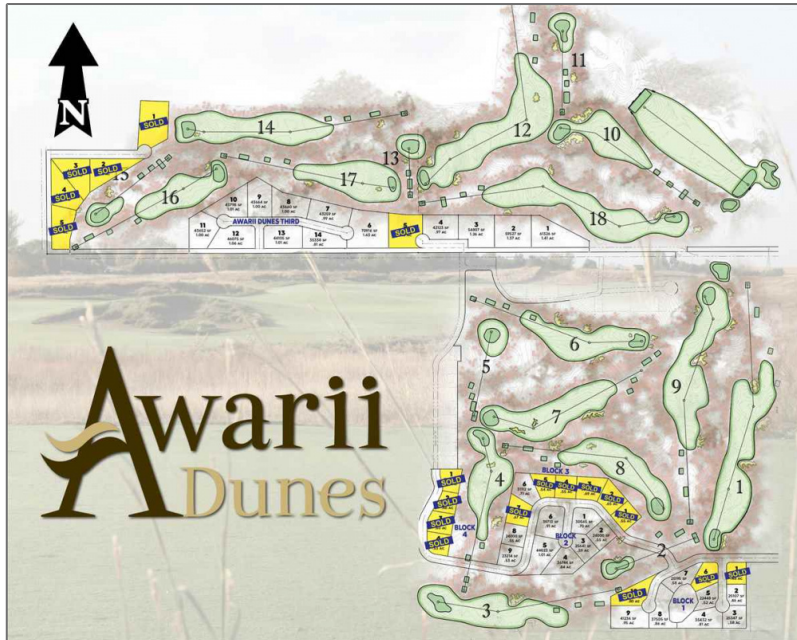

592 S Road Axtell, Nebraska 68924



## Property Description

Imagine a championship golf course in your own backyard and being able to play as often as you want. Enjoy watching the sunrises and sunsets, or gazing at the stars late at night. In central Nebraska, the opportunities to experience this are very limited. The Awarii Dunes Golf Club is an 18 hole championship course measuring approximately 7,000 yards built on sand hills just 5 minutes south of Kearney. Inspired by the great Links Courses of Ireland, Jim Engh created what he believes to be one of his best. Each hole uniquely designed to the natural layout of the land. On this 455 acre property, experience Awarii Dunes' rolling bent grass fairways, natural sand bunkers and manicured greens that draws golfers from afar. The club offers property owners a variety of options for golf and cart memberships as well as access to a prestigious golf academy. As a member of the Awarii community, the clubhouse can provide you with a venerable experience for weddings, receptions, graduation parties, corporate and family gatherings. Those that join the Awarii community enjoy not only a relaxing life style but lower real estate taxes as well. For 2019, the mill levy at Awarii was 1.1117 compared to 1.8551 in Kearney which represents real, significant savings today. Whether you seek an unprecedented golf experience or want to simply enjoy nature, consider making Awarii your new home. Awarii, Welcome Home.

### Basic Details

(308) 234-5550 - 3423 2nd Avenue, Kearney, NE 68847

Property Type: **Land**

Listing Type: **For Sale**

Listing ID: **20201332**

|        |                 |
|--------|-----------------|
| Price: | <b>\$75,000</b> |
|--------|-----------------|

|           |                  |
|-----------|------------------|
| Lot Area: | <b>0.81 Acre</b> |
|-----------|------------------|

---